

# KINGS COLLEGE BUDO

## HOLIDAY WORK TERM ONE

### Computer studies S.4

#### Set 1

1. a). Give reasons why many computer users prefer **GUI** other than **CLI**.  
c). **in** the screenshot below, name the GUI features labeled (A)-(E)

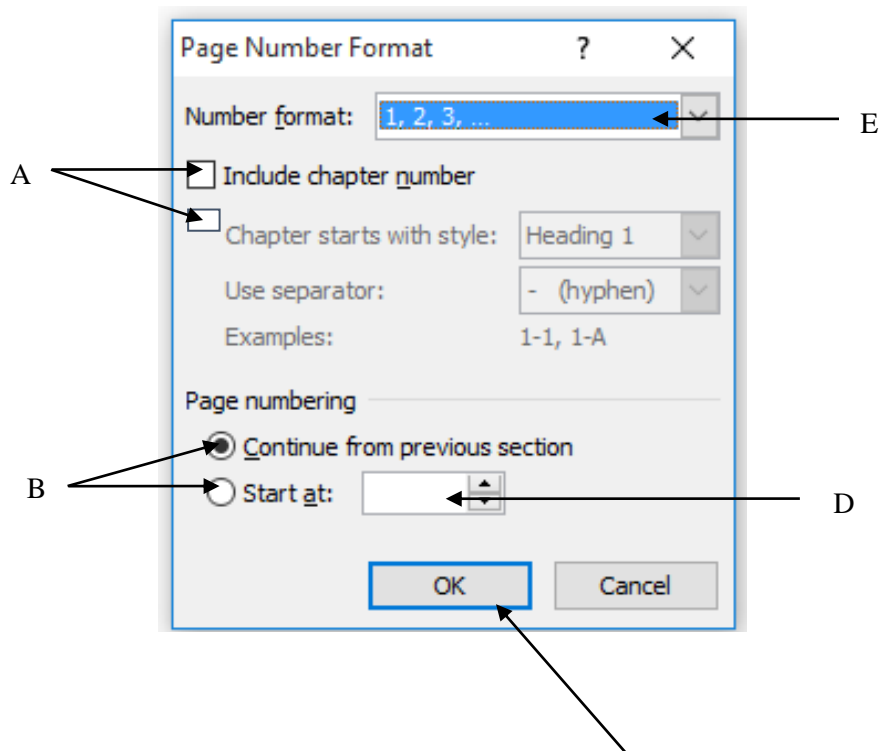

- d). Give one operational difference between feature **C** and **B**.
3. Outline the steps that can be followed to perform the following tasks.
  - i. Save a file on the desk top for the first time
  - ii. Shut down a desktop computer
  - iii. Start an application program
4. a). Under what circumstances can a computer user open and use each of the following application programs
  - i. Word processor software
  - ii. Spreadsheets software
  - iii. Presentation software
  - iv. Database management system
- b). Give one example of each of the application types given in (a) above

END

## Computer studies S.4

### Set 2

1. a). Assuming that an organization is faced with a challenge of choosing between **peer-to peer** network and **server based network**, outline five factors to consider before the final decision is made.  
  
b).Outline the advantages of a **peer- to- peer** LAN over a **server based** LAN
2. a).Assuming you have secured a contract of networking computers in a computer laboratory, sketch and explain four possible network layouts you can present to the contractor for approval.  
  
b).explain the problems the school may get when computers are connected to internet
3. a).Explain various reasons why you can support the proposal of allowing students at school to own and use smart phones.  
  
b).What are the dangers in this proposal if it is implemented?
4. a).You have been given a list of networking devices below by the head teacher and asked to explain the importance of each of them in computer networks.
  - i. ***Router***
  - ii. ***Modem***
  - iii. ***Repeater***
  - iv. ***Switch***
  - v. ***Hub***
  - vi. ***Network Interface Card***
  - vii. ***Twisted pair cable***  
b).As computer student, describe each device  
c).Give the difference between a **switch** and a **hub**  
d).If cables are to be left out, which other means can you advise the school to use  
e). Give the limitations of using the type of means mentioned in (d) above  
d).Explain the advantages of the school interconnect all computers with in the school.

END

## Computer studies S.4

### Set 3

1. a).List the benefits people are enjoying after computers developing from the **first** generation to the **fifth** generation  
b). outline the major technological advancements in the **1<sup>st</sup>, 2<sup>nd</sup>, 3<sup>rd</sup> and 4<sup>th</sup>** generations
2. a).Which name is given to the computer hardware below?



- b). List 10 hardware components that are housed in this computer hardware
- c). which one of components mention in (a) above is responsible for the following
  - i. Converting alternative current to direct current for the computer to use
  - ii. Providing power to a chip that keeps settings like date and time
  - iii. Writing and reading information onto and from a CD or DVD
  - iv. Containing data permanently and it is fixed on the keyboard.
3. a).Differentiate between digital and analog signals  
b).Mention three ways in which computers can be classified
4. Give one difference in each of the following cases
  - a. An **Impact printer** and **Non- impact printer**
  - b. A **CRT monitor** and **LCD monitor**
  - c. A **Mouse** and a **Key board**
  - d. Read only Memory and Random Access Memory

END